

Access & Floor Map

Access

Trains

- Take the JR Kyoto line from Osaka station and get off at Takatsuki station. (8 min-walk from the south exit)
- Take the Hankyu Kyoto line and get off at Takatsuki-shi station, and come out from Exit 1.

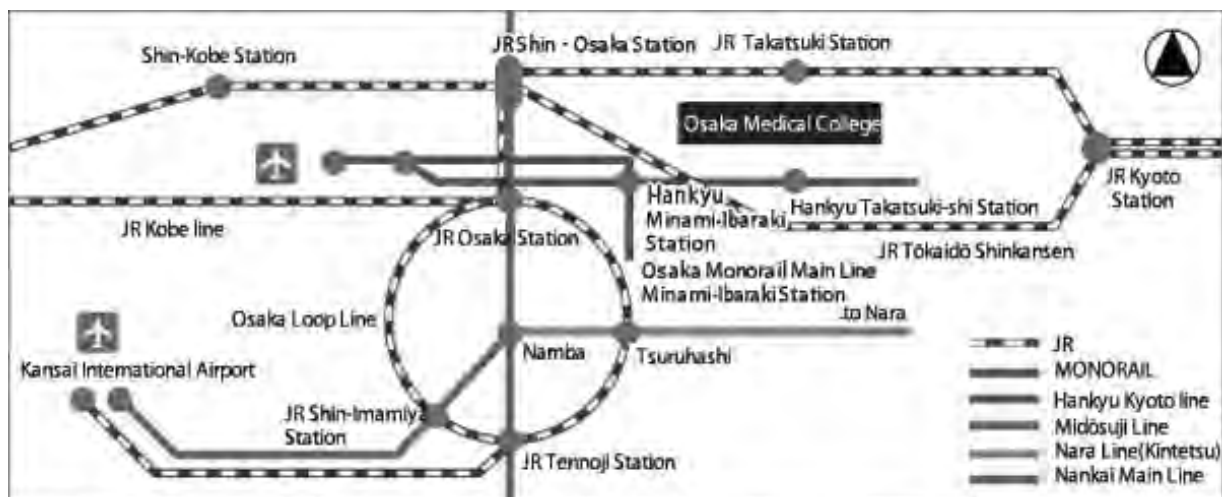

SUPER BULLET TRAINS (shinkan-sen)

- (from Shin-Osaka)
Get off at Shin-Osaka station and take the Kyoto line to Takatsuki (10 min. by Special Rapid Service)
- (from Kyoto)
Getting off at Kyoto station, take the Kyoto line to Takatsuki station. (12 min. by Special Rapid Service)

MONORAIL (from Itami Airport)

- Take the monorail from Osaka International (Itami) Airport Station and get off at Minami-Ibaraki Station.
Change trains to the Hankyu line, take the Kyoto line towards Kawaramachi to get to Takatsuki-shi. station (55 min.)

From KANSAI AIRPORT (KIX)

- Take the airport Express “Haruka” from JR Kansai International Airport and get to Shin-Osaka.
Change to the JR Kyoto line and take the train to Kyoto, and get off at Takatsuki station.(about 90 min.)
- Take the airport limousine bus going to JR Ibaraki station and get off at “Hankyu” Ibaraki station.
Take the Hankyu train going to Kyoto and get off at Takatsuki-shi station. (about 100 min.)

Floor Map

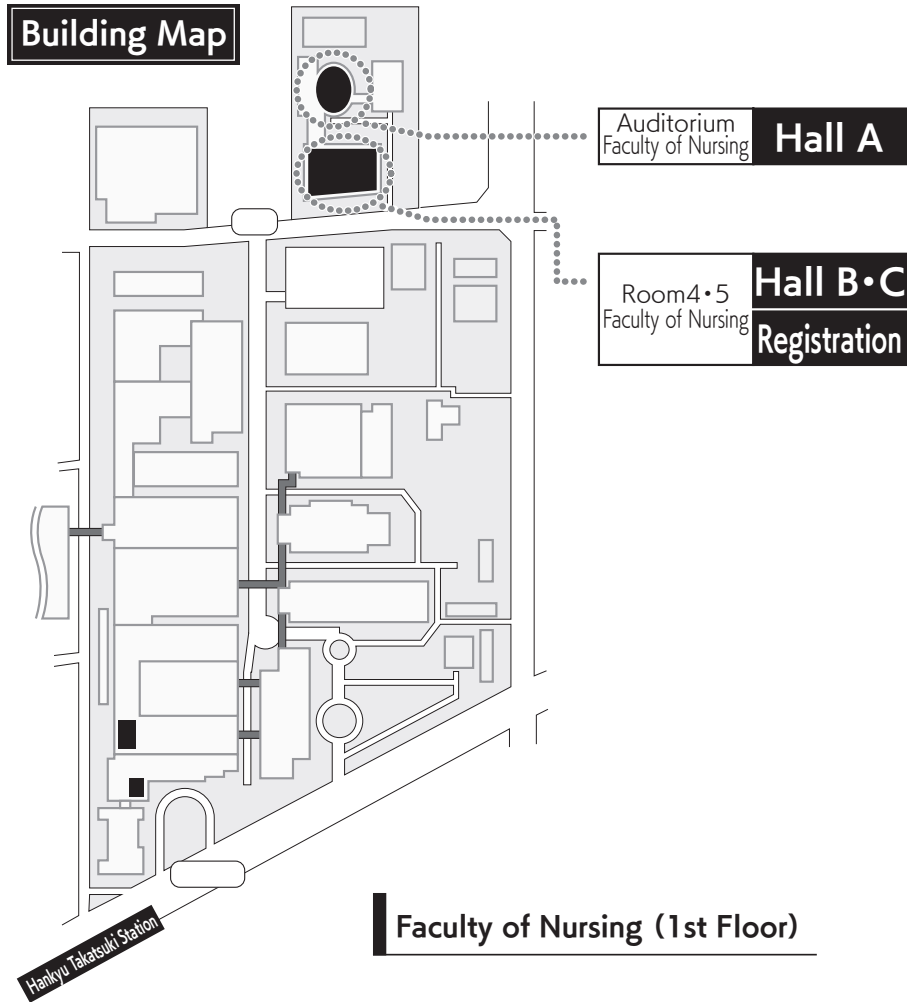

Faculty of Nursing (1st Floor)

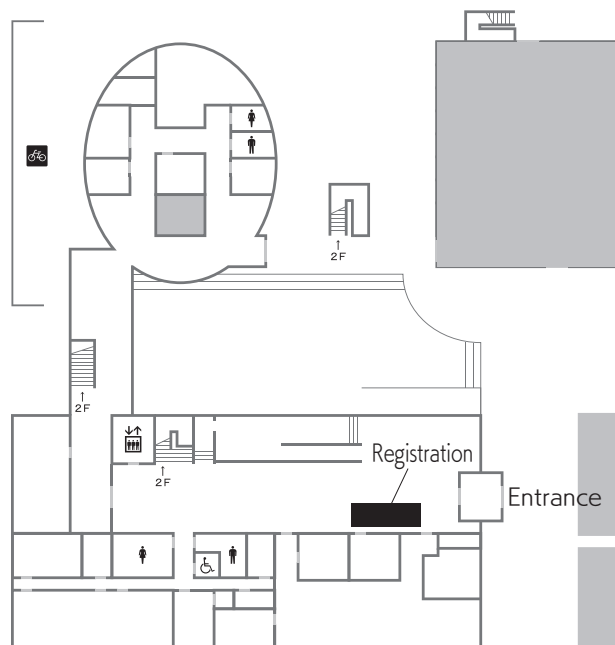

Faculty of Nursing (2nd Floor)

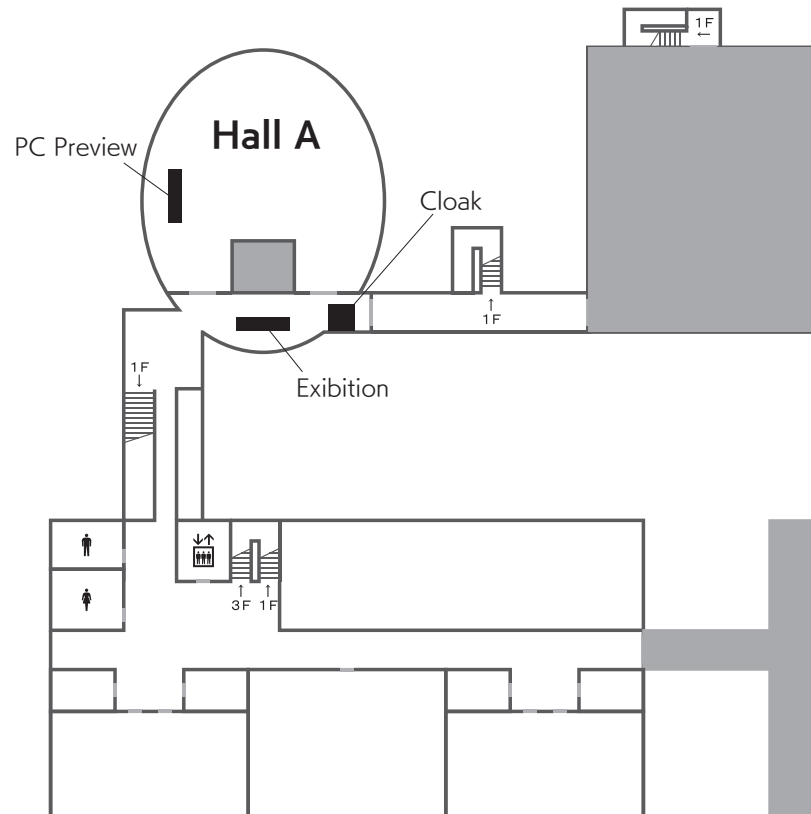

Faculty of Nursing (3rd Floor)

